

UPPER FLOOR

456 SQ. FT.

8'-0" CEILING

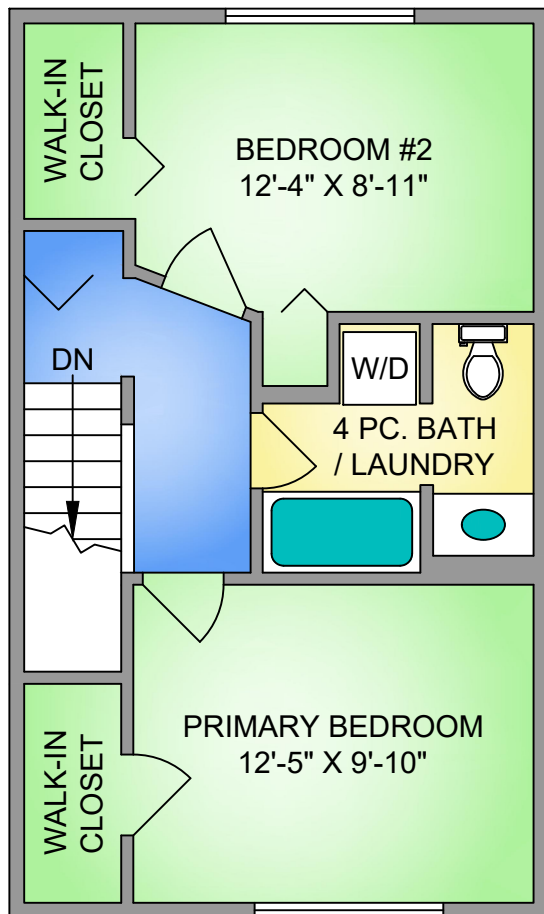

MAIN FLOOR

456 SQ. FT.

8'-0" CEILING

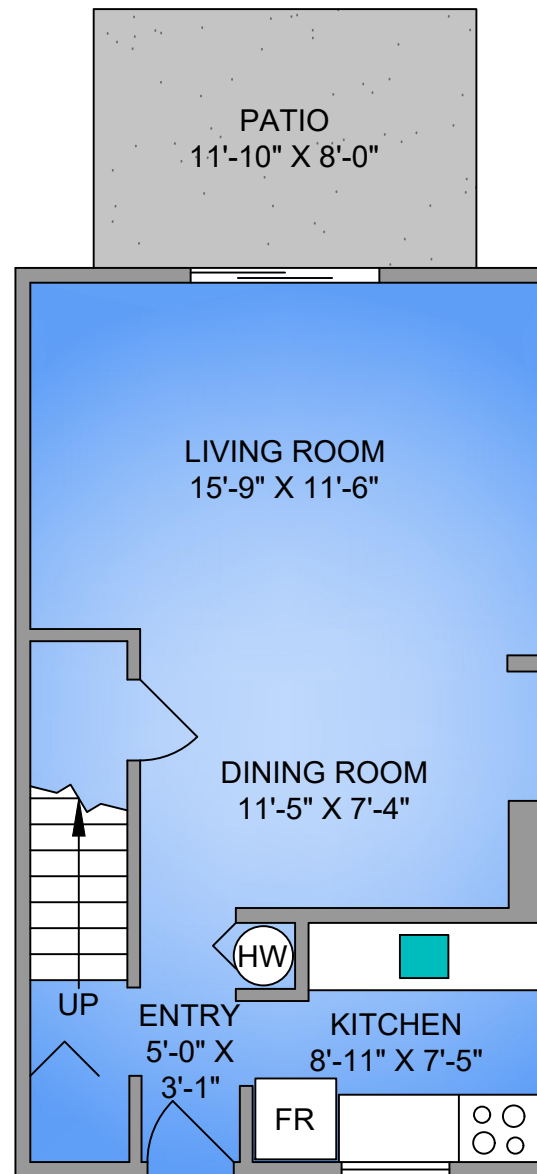

21-25 PRYDE AVENUE

MARCH 27, 2025

This floor plan has been laser measured and drafted by a professional Drafting Technician using AutoCAD software. Private resale or modification of this copyrighted document to a third party by any individual or entity, other than the original creator is strictly prohibited. Plans may not be 100% accurate. Buyer must verify any critical measurement.

FLOOR	AREA (SQ. FT.)	
	FINISHED	DECK / PATIO
MAIN	456	95
UPPER	456	-
TOTAL	912	95

NORTH

