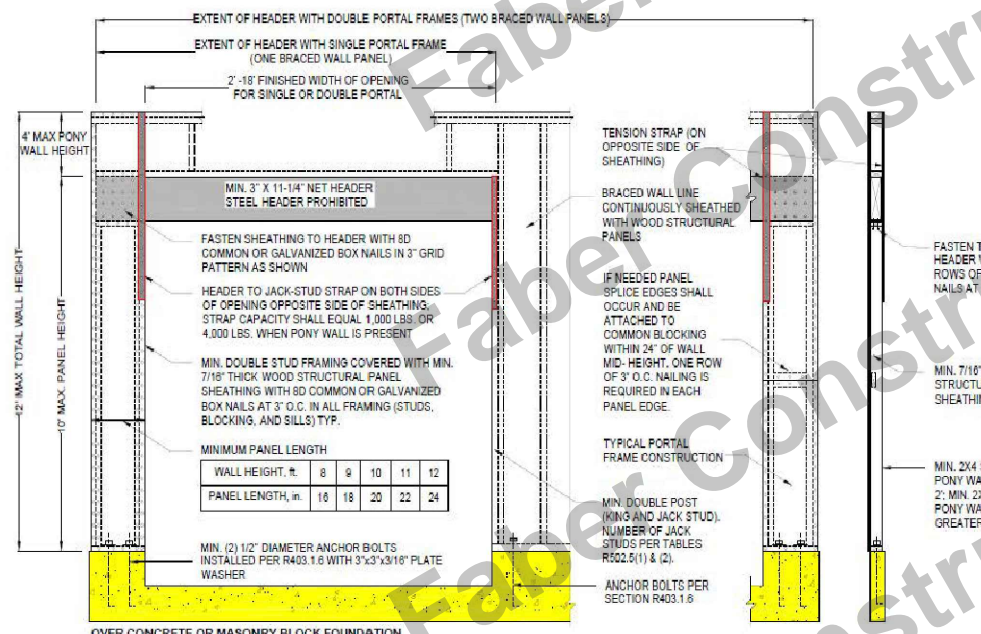

Figure 321.25-A
PF - PORTAL FRAME BRACE CONSTRUCTION



WALL BRACING

EXTERIOR BRACED WALL PANEL IS REQUIRED TO BE 12'-6" FROM CORNERS WITH A MAXIMUM SPACING OF 21' FROM CENTER OF BRACED PANEL TO CENTER OF BRACED PANEL. ALL EXT. AND MATE WALLS ARE COVERED WITH WALL SHEATHING. NOTE: ALL SHEATHING PANELS ARE INSTALLED VERTICALLY & PROPERLY FASTENED TO TABLE R602.10.4/321.25-G TO INSURE ALL PANELS CONSIDERED BRACED PANEL UNLESS OTHERWISE NOTED ON PLAN IN SPECIFIC LOCATIONS. NOTE: SHEATHING MUST OVERLAP FROM 1ST FLOOR WALL TO KNEEWALL BELOW BY 6" MIN. ALL SHEATHING SPLICES TO BE BLOCKED.

SPS TABLE 321.25-G CONTINUOUS SHEATHING METHODS
METHOD- CS-WSP
MATERIAL- WOOD STRUCTURAL PANEL
MINIMUM THICKNESS- 3/8"
CONNECTION CRITERIA- 6d common (2" x 0.113") nails at 6" spacing (panel edges) and at 12" spacing (intermediate supports) or 16 ga. x 1 3/4 staples at 3" spacing (panel edges) and 6" spacing (intermediate supports)

DREAM DESIGNS
EMAIL: AARON.AVGURU@GMAIL.COM
PH: (715) 207-7120

BUILDER:	FABER CONSTRUCTION													
CUSTOMER:	JEREMY FABER MINOCQUA, WI													
SQ. FT:	1040 LIVING													
MODEL:	32' x 32' ROCKWOOD SPEC1													
REVISIONS														
DATE	DESCRIPTION	BY	DATE	DESCRIPTION	BY	DATE	DESCRIPTION	BY	DATE	DESCRIPTION	BY	DATE	DESCRIPTION	BY
5-11-22	PRELIM	AJL	3-21-23	OPTION #2	AJL									
8-6-22	REV #1	AJL	4-5-23	REV #2	AJL									
8-30-22	PACKAGE	AJL	7-7-23	REV #3	AJL									
7-5-23	FINALS	AJL												
TITLE: FIRST FLOOR PLAN														
SCALE: 1/4"=1'														
PAGE: A100														

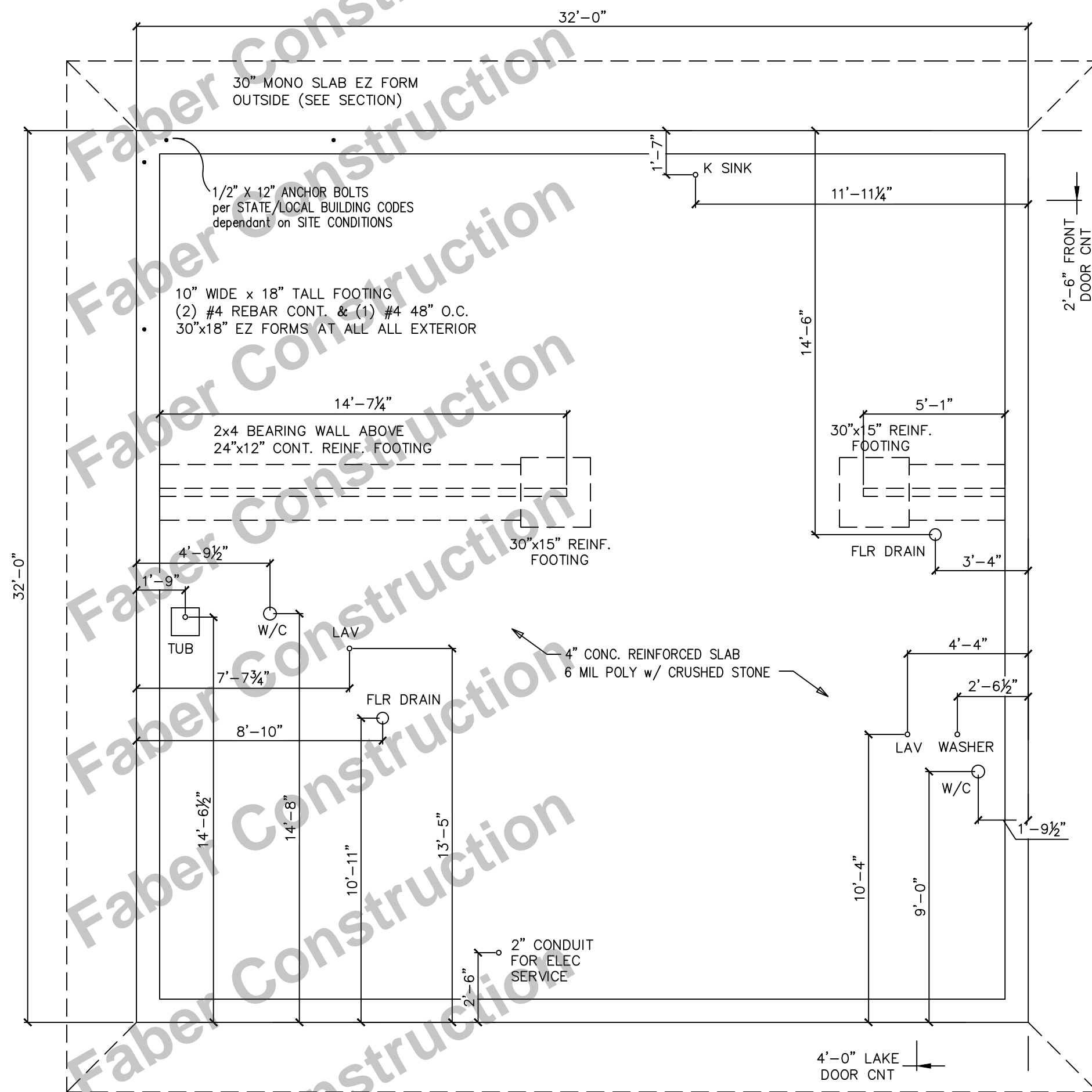

DREAM DESIGNS
 EMAIL: AARON.AVGURU@GMAIL.COM
 PH: (715) 207-7120

BUILDER:	FABER CONSTRUCTION													
CUSTOMER:	JEREMY FABER MINOCQUA, WI													
SQ. FT.:	1040 LIVING													
MODEL:	32' x 32' ROCKWOOD SPEC1													
REVISIONS														
DATE	DESCRIPTION	BY	DATE	DESCRIPTION	BY	DATE	DESCRIPTION	BY	DATE	DESCRIPTION	BY	DATE	DESCRIPTION	BY
5-11-22	PRELIM	AJL	3-21-23	OPTION #2	AJL									
8-6-22	REV #1	AJL	4-6-23	REV #2	AJL									
8-30-22	PACKAGE	AJL	7-7-23	REV #3	AJL									
7-5-23	FINALS	AJL												
													TITLE:	
													FOUNDATION	
													SCALE: 1/4"=1'	
													PAGE:	
													A200	

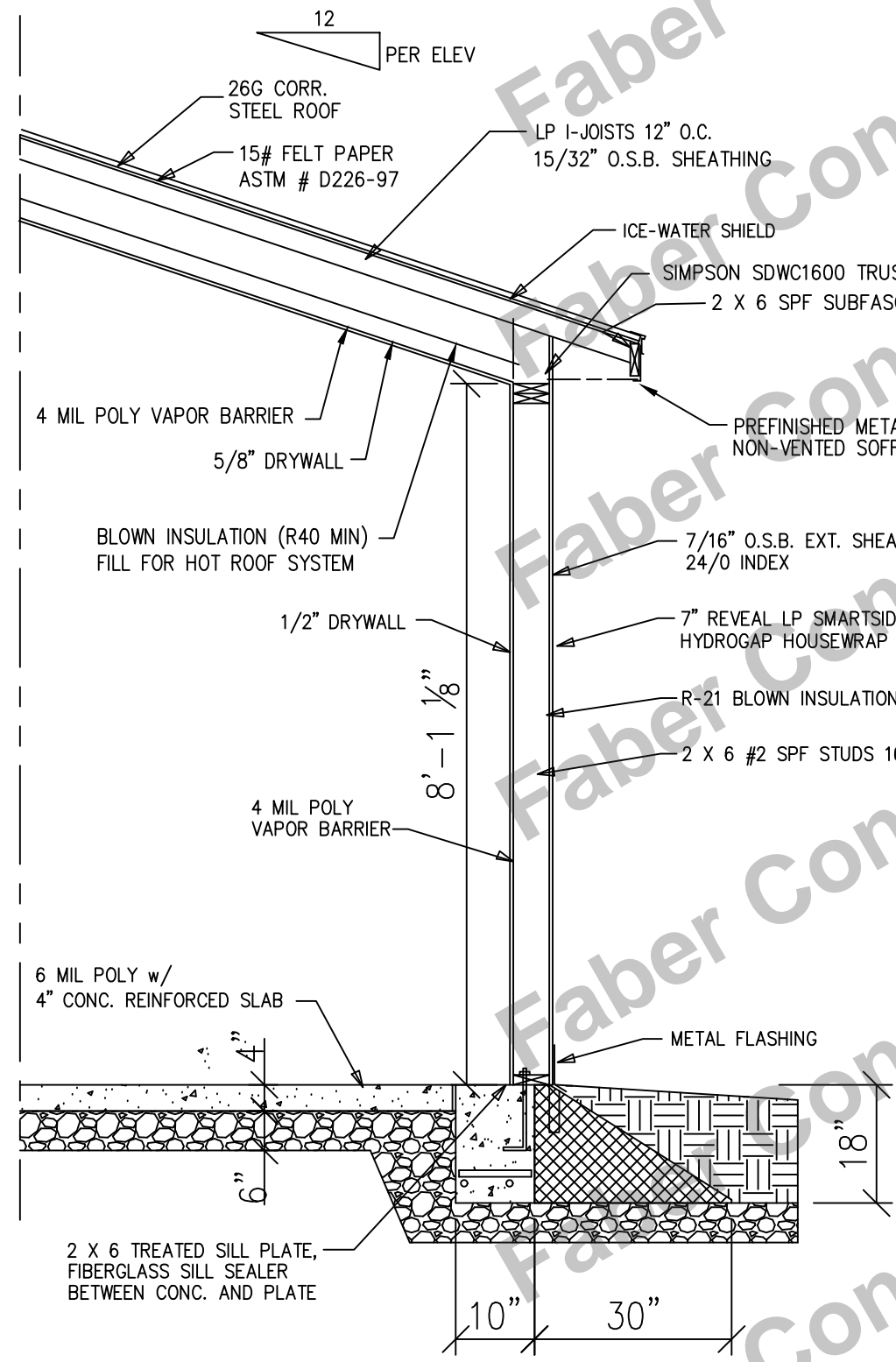

10" WIDE x 18" TALL FOOTING
 (2) #4 REBAR CONT. & (1) #4 48" O.C.
 30"x18" EZ FORMS AT ALL ALL EXTERIOR
 1/2" ANCHOR BOLTS INTO 2x6 WOOD WALLS
 TREATED BOTTOM PLATES ON SILL SEAL
 METAL FLASHING AT EXT. OSB TO EZ-FORM

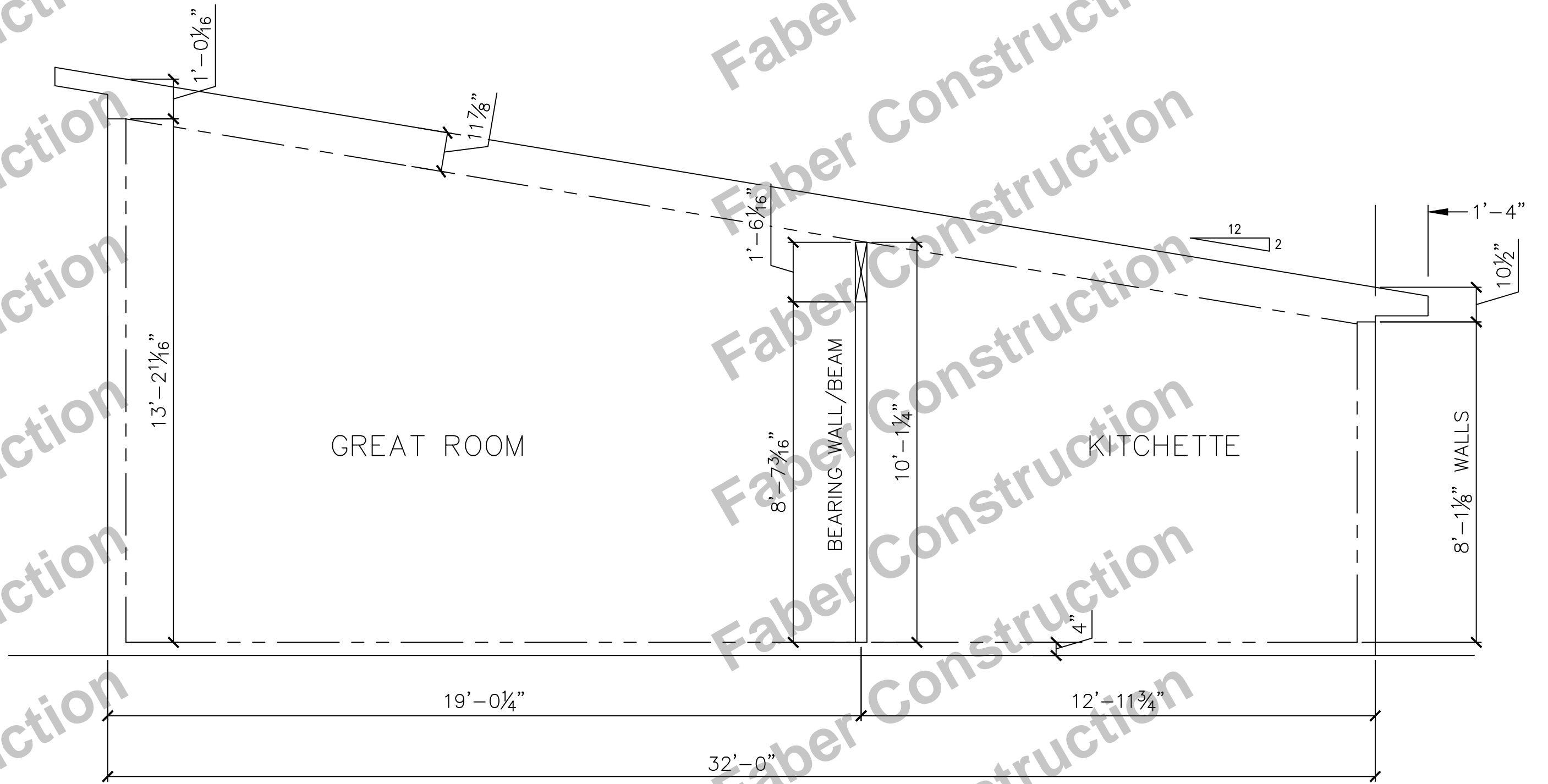

DREAM DESIGNS
 EMAIL: AARON.AVGURU@GMAIL.COM
 PH: (715) 207-7120

BUILDER:		REVISIONS											
FABER CONSTRUCTION		DATE	DESCRIPTION	BY	DATE	DESCRIPTION	BY	DATE	DESCRIPTION	BY	DATE	DESCRIPTION	BY
CUSTOMER:	JEREMY FABER MINOCQUA, WI	5-11-22	PRELIM	AJL	3-21-23	OPTION #2	AJL						
SQ. FT.:	1040 LIVING	8-6-22	REV #1	AJL	4-5-23	REV #2	AJL						
MODEL:	32' x 32' ROCKWOOD SPEC1	8-30-22	PACKAGE	AJL	7-7-23	REV #3	AJL						
		7-5-23	FINALS	AJL									

TITLE: SECTIONS
 SCALE: 3/8"=1'
 PAGE:
S100

