

LOWER FLOOR
923 SQ. FT. (UNFINISHED)
6'-0" - 7'-0" CEILING HEIGHT

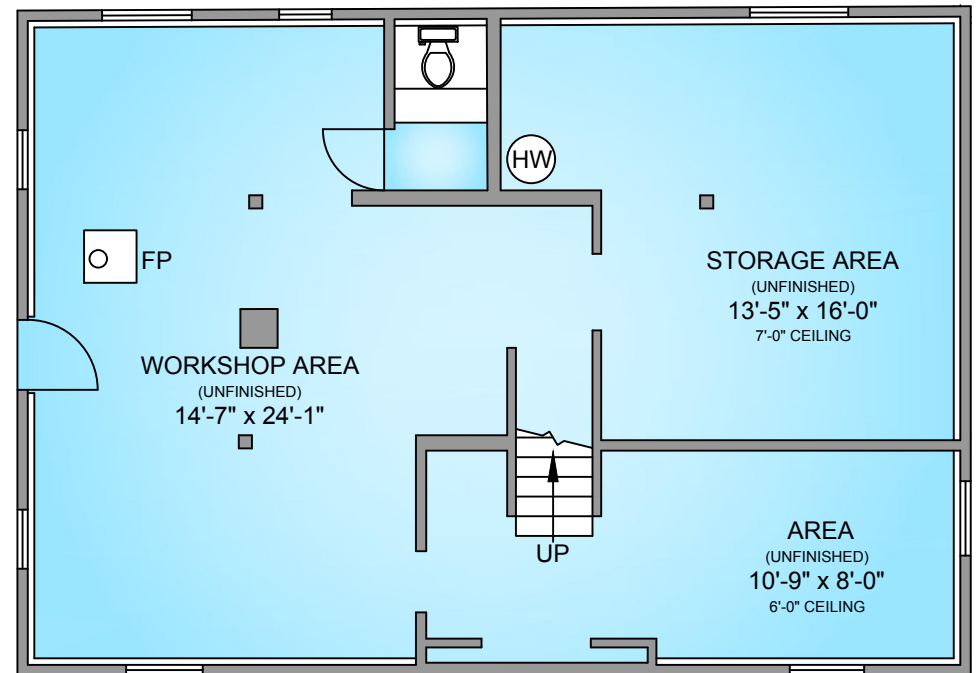

1531 COWICHAN BAY ROAD
OCTOBER 25, 2023
PREPARED FOR THE EXCLUSIVE USE OF THERESA CARTER.
PLANS MAY NOT BE 100% ACCURATE, IF CRITICAL BUYER TO VERIFY.

FLOOR	TOTAL	AREA (SQ. FT.)		
		FINISHED	UNFINISHED	DECK / PATIO
MAIN	1012	1012	-	120
UPPER	386	386	-	-
LOWER	923	-	923	-
TOTAL	2321	1398	923	120