

6607 Mountainview Dr, Oliver, BC

Main Floor Exterior Area 1166.87 sq ft
Interior Area 1071.32 sq ft
Excluded Area 384.75 sq ft

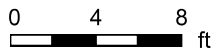

PREPARED: 2025/01/15



White regions are excluded from total floor area in iGUIDE floor plans. All room dimensions and floor areas must be considered approximate and are subject to independent verification.

6607 Mountainview Dr, Oliver, BC

Basement (Below Grade) Exterior Area 1067.23 sq ft
Interior Area 961.02 sq ft

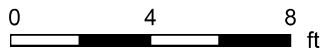

PREPARED: 2025/01/15



6607 Mountainview Dr, Oliver, BC

Garage Excluded Area 338.45 sq ft

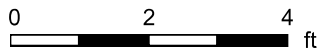
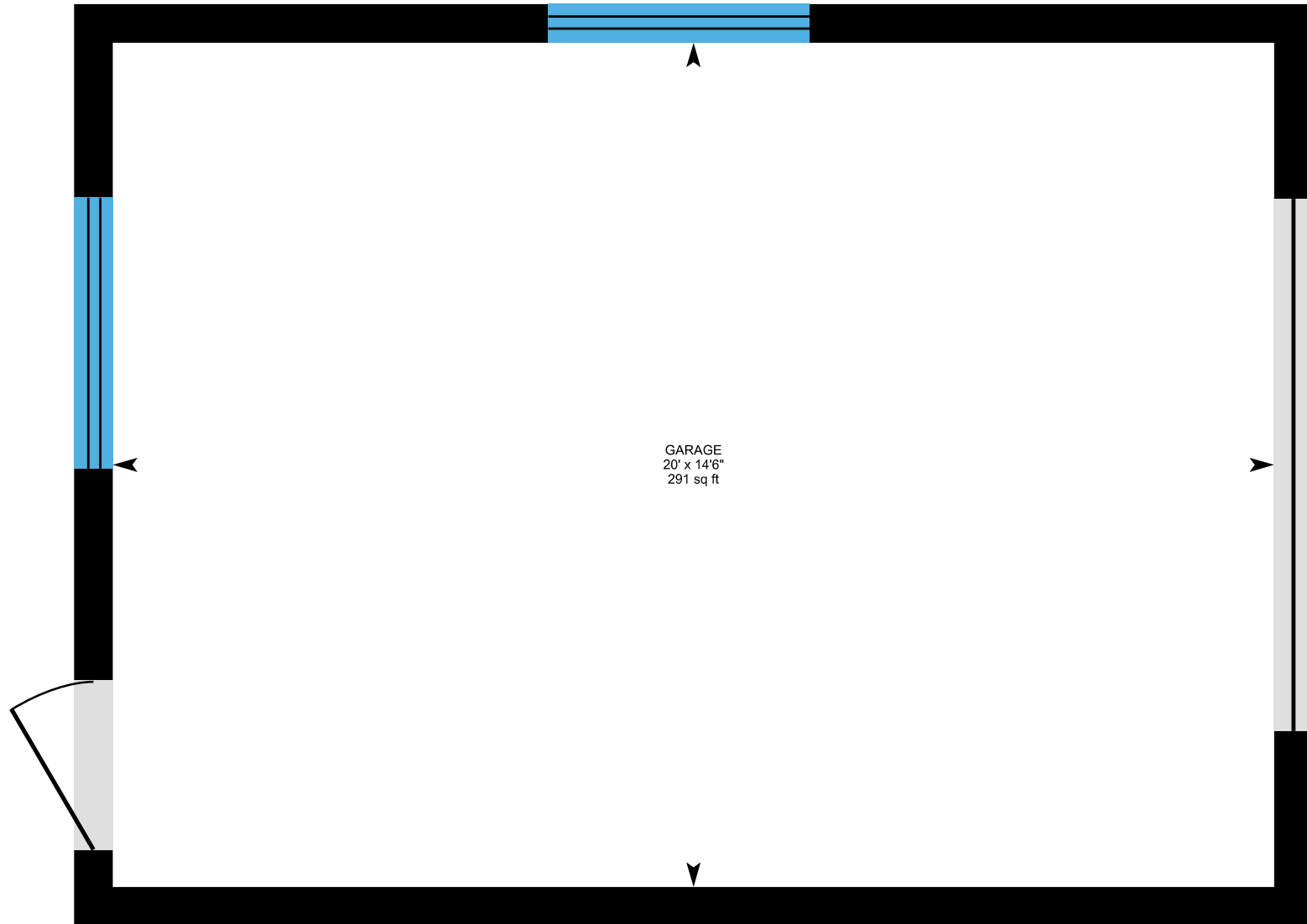

PREPARED: 2025/01/15

