

MAIN FLOOR
1,388 SQ. FT.

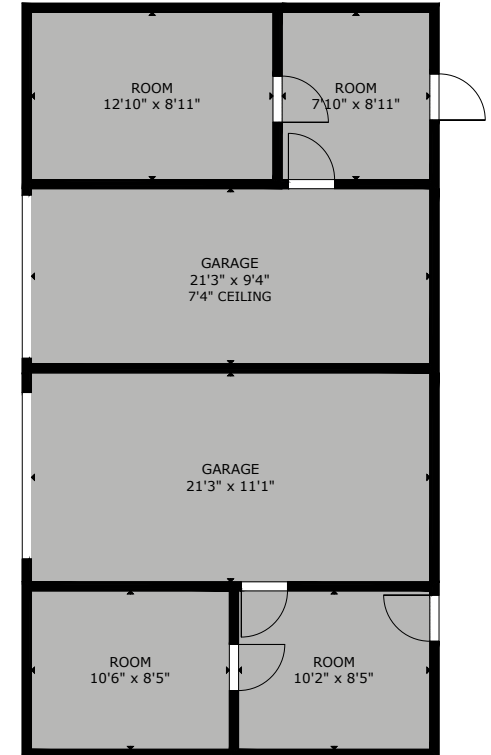

GARAGE
832 SQ. FT.



2871 LOWERY ROAD

	FINISHED	UNFINISHED	DECK/PATIO	GARAGE
MAIN	1388	-	893	832
TOTAL	1388	-	893	832

SIZE AND DIMENSIONS ARE APPROXIMATE, ACTUAL MAY VARY
PREPARED FOR THE EXCLUSIVE USE OF

JASON FINLAYSON

MEASURED ON 14/08/24, BY STELLAR REAL ESTATE MARKETING
www.stellarca.ca | +1 (250) 929 1888 | info@stellarca.ca

