

6-2369 MALAVIEW AVE

SIDNEY, BC

Main Floor	501 SQ.FT.
Upper Floor	557 SQ.FT.
Total	1058 SQ.FT.
Patio	234 SQ.FT.

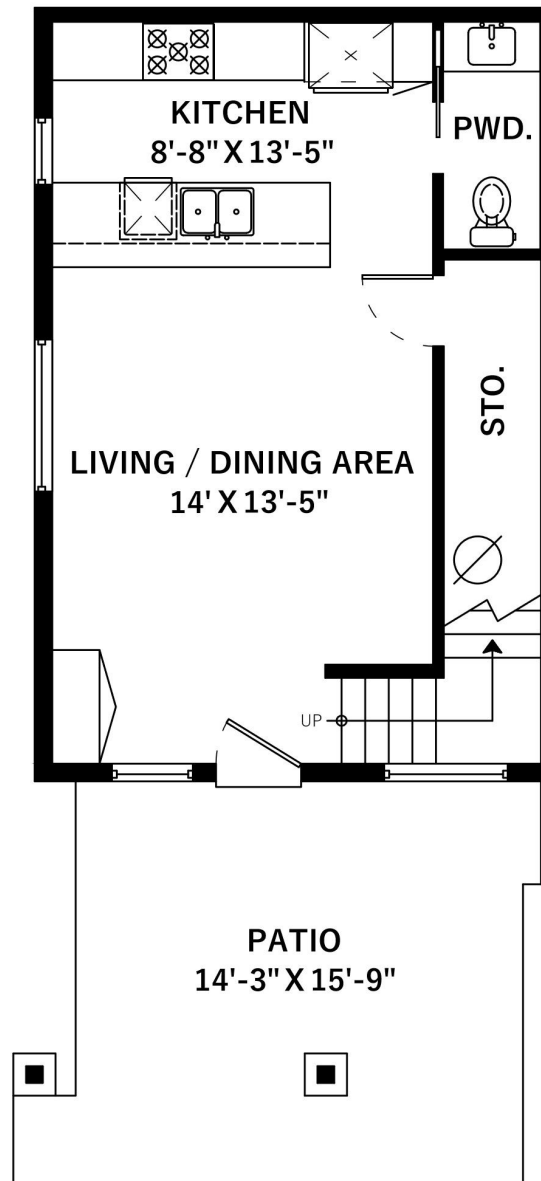

Main Floor: 501 Sq.Ft.
Ceiling Height: 9'

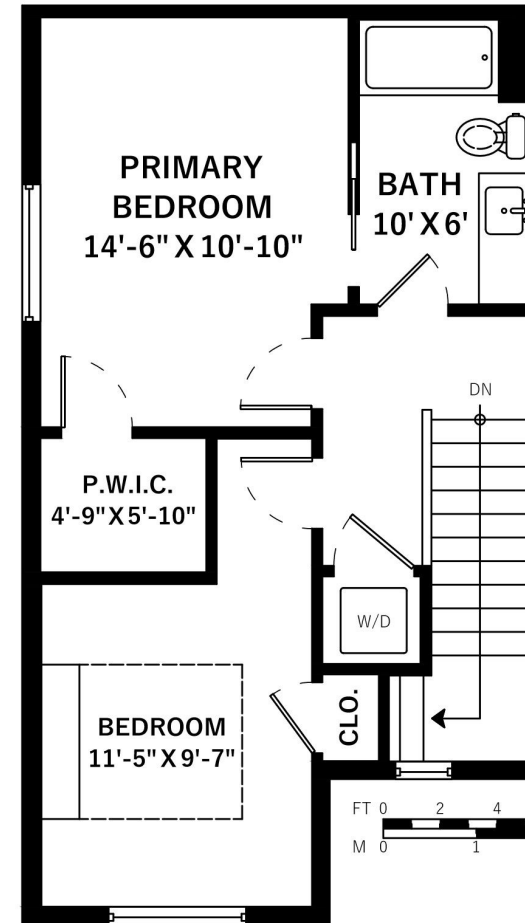

Upper Floor: 557 Sq.Ft.
Ceiling Height: 8'

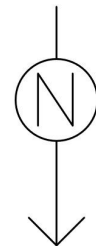

WWW.RICKHUMPHRIES.COM

SUPPLIED BY:

**MATTHEW JAMES
PHOTOGRAPHY**

WWW.MATTHEWJAMESPHOTO.CA