

104-35 Rivermount Pl, Fernie, BC

Main Floor Total Exterior Area 951 sq ft
Total Interior Area 871 sq ft

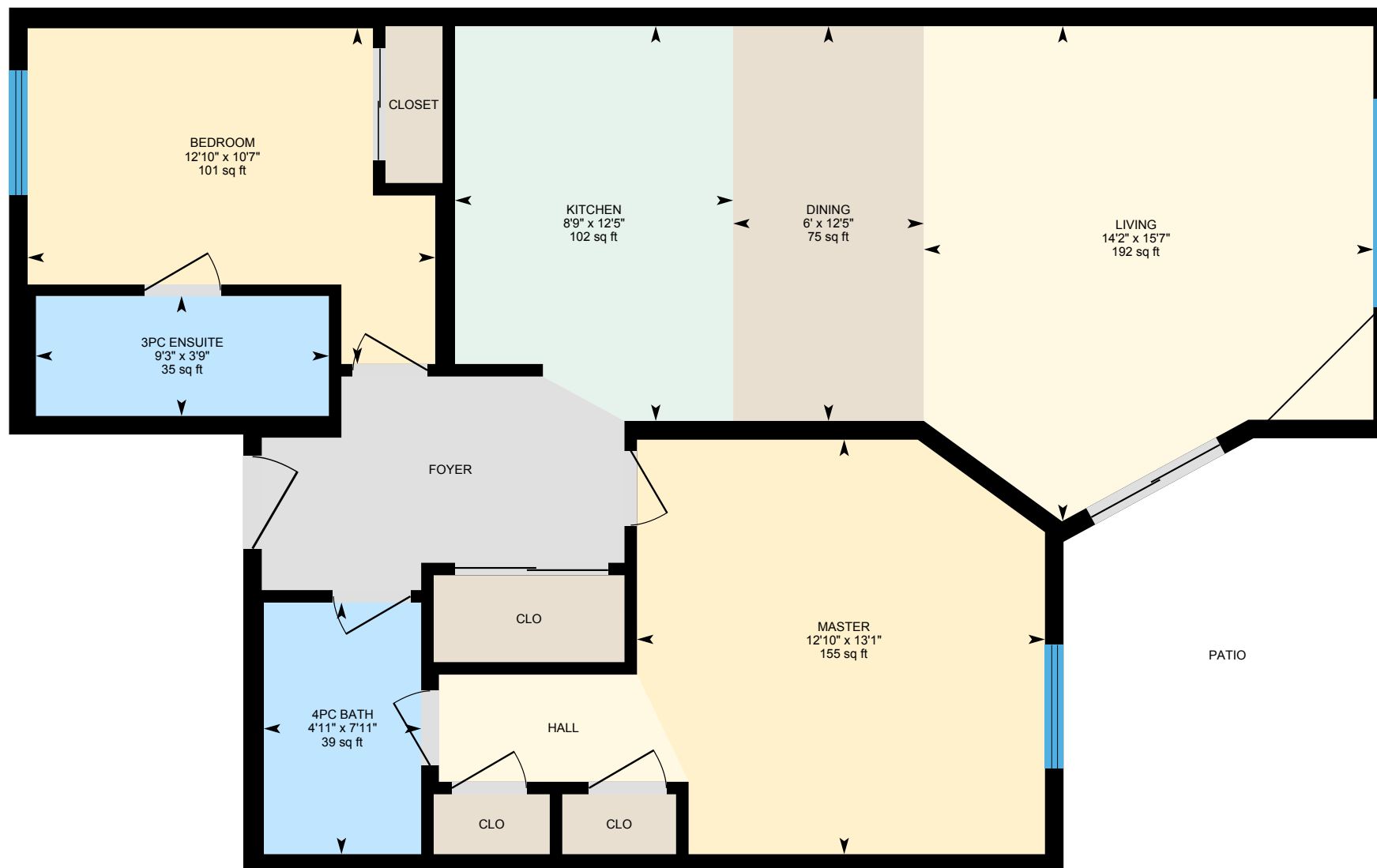

0 4 8 ft

PREPARED: Aug, 2020



White regions are excluded from total floor area. All room dimensions and floor areas must be considered approximate and are subject to independent verification. For method of measurement please see <https://youriguide.com/measure/>.

iGUIDE

104-35 Rivermount Pl, Fernie, BC

Property Details

Room Measurements

Only major rooms are listed. Some listed rooms may be excluded from total interior floor area (e.g. garage). Room dimensions are largest length and width; parts of room may be smaller. Room area is not always equal to product of length and width.

Main Building

MAIN FLOOR

3pc Ensuite: 3'9" x 9'3" | 35 sq ft
4pc Bath: 7'11" x 4'11" | 39 sq ft
Bedroom: 10'7" x 12'10" | 101 sq ft
Dining: 12'5" x 6' | 75 sq ft
Kitchen: 12'5" x 8'9" | 102 sq ft
Living: 15'7" x 14'2" | 192 sq ft
Master: 13'1" x 12'10" | 155 sq ft

Floor Area Information

For explanation of floor area calculations and method of measurement please see <https://youriguide.com/measure/>. All displayed floor areas are rounded to nearest integer. Total area is computed before rounding and may not equal to sum of displayed floor areas.

Main Building

MAIN FLOOR

Interior Area: 871 sq ft
Perimeter Wall Length: 137 ft
Perimeter Wall Thickness: 7.0 in
Exterior Area: 951 sq ft

Total Above Grade Floor Area

Main Building Interior: 871 sq ft
Main Building Exterior: 951 sq ft