

BASEMENT FLOOR PLAN
- 1067 SQ. FT. (INCLUDING STAIRS)

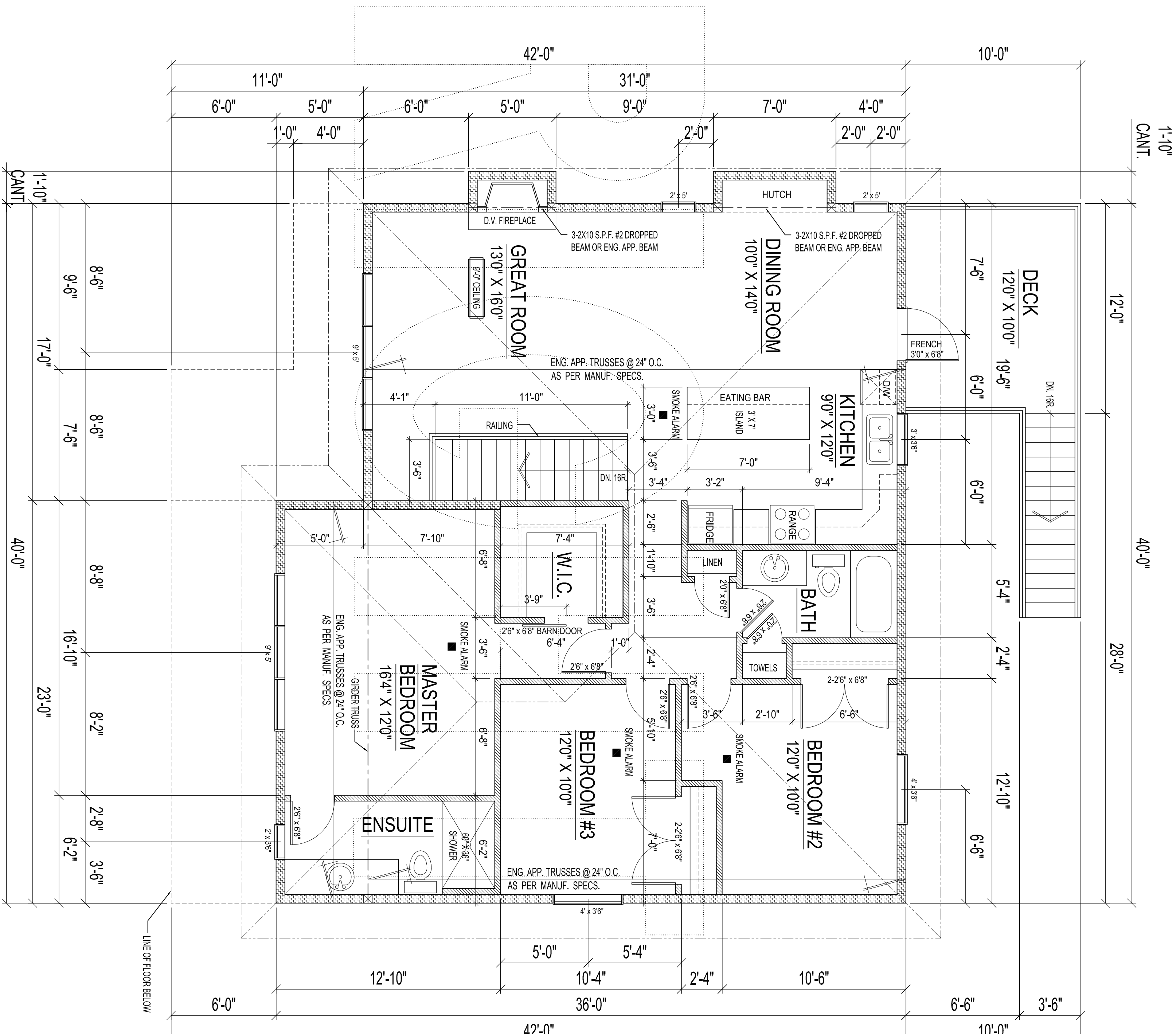

MAIN FLOOR PLAN
- 1377 SQ. FT.

NOTE:
L-JOIST/TRUSS DIRECTIONS AND LOCATION OF BEAM/GIRDER TRUSSES TO BE CONFIRMED WITH FLOOR/TRUSS MANUFACTURER
FRAMER NOTE:
FRAME ALL MAIN FLOOR & BASEMENT WINDOWS @ 8'-0" HEIGHT EXCEPT AS NOTED.

notes:
Contractor/Builder shall verify all dimensions and details and notify the designer of any errors or omissions prior to the commencement of any work. All drawings are the instruments of Pro-X Design & Drafting and shall not be used without the permission of Pro-X Design & Drafting.

drawn by: D.G.M.
approved by: D.G.M.
date: OCTOBER 2023
scale: 1/4" = 1'-0"

project: **MARINO Construction**
title: 5585 COSTER PLACE - 1377 SQ.FT. MAIN FLOOR & BASEMENT PLANS