

806-75 Martin St, Penticton, BC

Main Floor Total Exterior Area 993 sq ft
Total Interior Area 809 sq ft

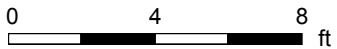

PREPARED: Jul, 2020

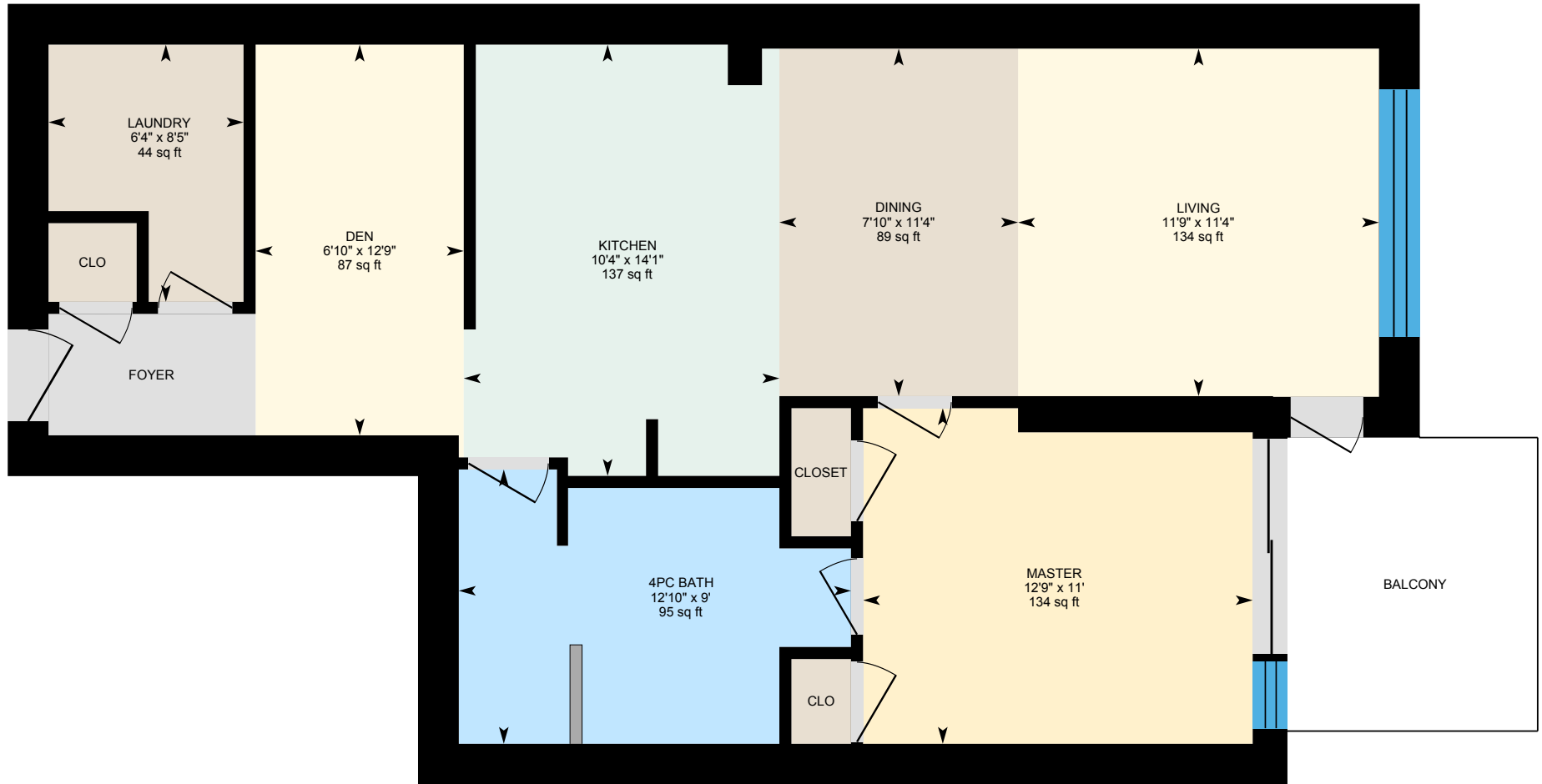

White regions are excluded from total floor area. All room dimensions and floor areas must be considered approximate and are subject to independent verification. For method of measurement please see <https://youriguide.com/measure/>.

806-75 Martin St, Penticton, BC

Property Details

Room Measurements

Only major rooms are listed. Some listed rooms may be excluded from total interior floor area (e.g. garage). Room dimensions are largest length and width; parts of room may be smaller. Room area is not always equal to product of length and width.

Main Building

MAIN FLOOR

4pc Bath: 9' x 12'10" | 95 sq ft
Den: 12'9" x 6'10" | 87 sq ft
Dining: 11'4" x 7'10" | 89 sq ft
Kitchen: 14'1" x 10'4" | 137 sq ft
Laundry: 8'5" x 6'4" | 44 sq ft
Living: 11'4" x 11'9" | 134 sq ft
Master: 11' x 12'9" | 134 sq ft

Floor Area Information

For explanation of floor area calculations and method of measurement please see <https://youriguide.com/measure/>. All displayed floor areas are rounded to nearest integer. Total area is computed before rounding and may not equal to sum of displayed floor areas.

Main Building

MAIN FLOOR

Interior Area: 809 sq ft
Perimeter Wall Length: 138 ft
Perimeter Wall Thickness: 16.0 in
Exterior Area: 993 sq ft

Total Above Grade Floor Area

Main Building Interior: 809 sq ft
Main Building Exterior: 993 sq ft