

PROJECT	LE CANAL
DETAIL	TIKI BAR KITCHEN
PROJECT NO.	
ISSUE DATE:	March 2025
REVIEWED BY:	
DRAWN BY:	Y.PACHECO
REVISIONS	05
No. BY	DESCRIPTION DATE

**FOR REVISION ONLY**

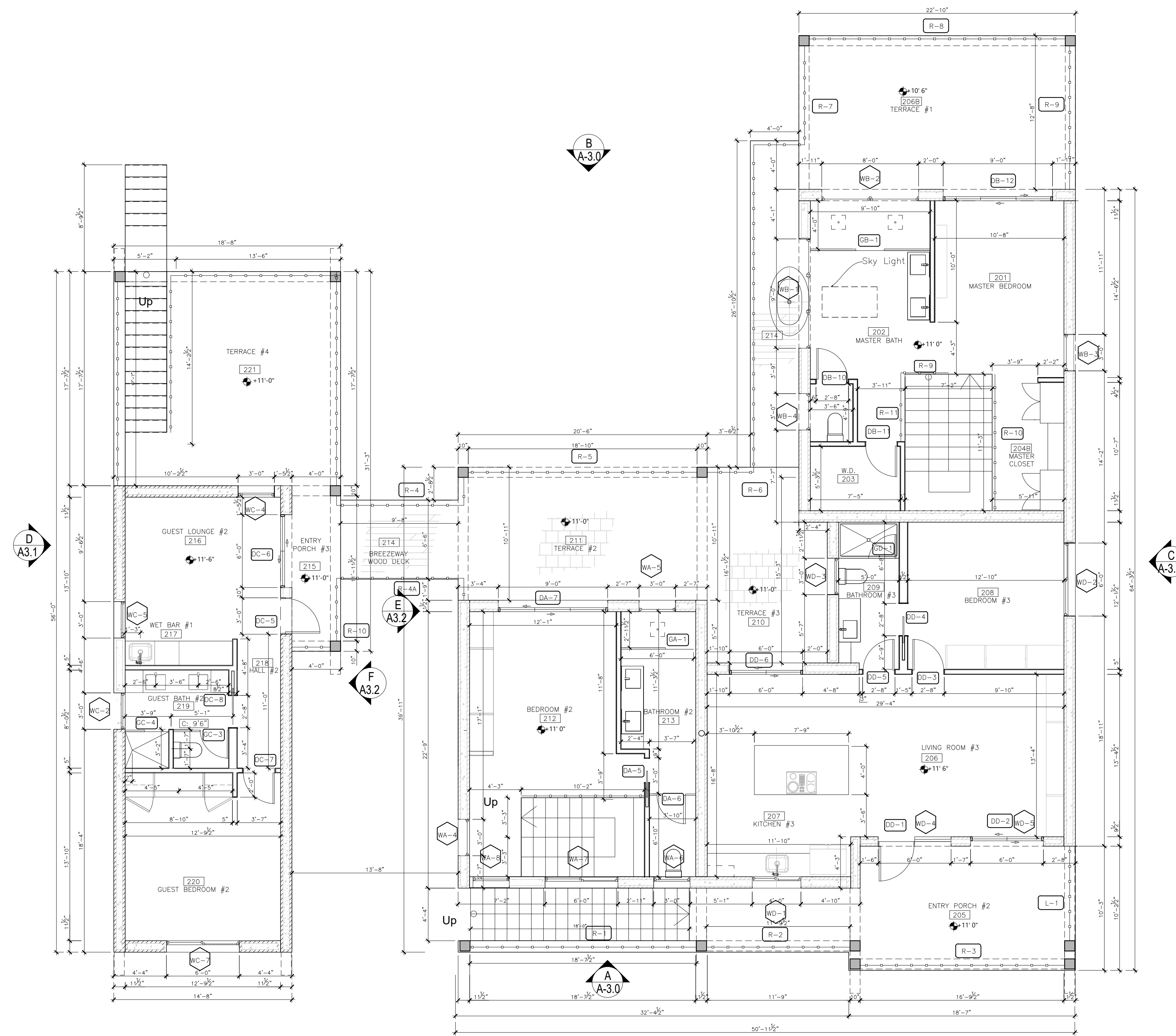

**ROOM NUMBER**

- |                       |                       |
|-----------------------|-----------------------|
| 101 MAIN ENTRANCE     | 201 MASTER BEDROOM    |
| 102 KITCHEN           | 202 MASTER BATHROOM   |
| 103 DINING            | 203 WASHER & DRYER    |
| 104 POWDER ROOM #1    | 204 MASTER CLOSET     |
| 105 MUD ROOM          | 205 ENTRANCE PORCH    |
| 106 PANTRY #1         | 206 LIVING ROOM #3    |
| 107 ELECTRICAL ROOM   | 207 KITCHEN #3        |
| 109 STORAGE #2        | 208 BEDROOM #3        |
| 110 STORAGE #3        | 209 BATHROOM #3       |
| 111 LAUNDRY           | 210 TERRACE #3        |
| 112 ENTRANCE #2       | 211 TERRACE #2        |
| 113 KITCHEN #2        | 212 BEDROOM #2        |
| 114 LIVING ROOM #2    | 213 BATHROOM #2       |
| 115 POWDER ROOM #2    | 214 BREEZEWAY         |
| 116 STORAGE #1        | 215 ENTRY PORCH #3    |
| 117 TERRACE #3        | 216 GUEST LOUNGE #3   |
| 118 STORAGE #4        | 217 WET BAR #2        |
| 119 ENTRY PORCH #1    | 218 HALL #2           |
| 120 GUEST LOUNGE #1   | 219 GUEST BATHROOM #2 |
| 121 WET BAR #1        | 220 GUEST BEDROOM #2  |
| 122 HALL #1           | 221 TERRACE #1        |
| 123 GUEST BATHROOM #1 |                       |
| 124 GUEST BEDROOM #1  |                       |

**NOTES:**

- All dimensions are done in imperial.
- Do not scale drawings. Use given dimension only.
- Use given dimensions only. All dimensions to be confirmed on site prior commencement.
- All exterior gutter, downspout assembly, rain chain links, hood vents, wet stacks, drip edges shall be in cooper.
- Attic access opening shall be 22" x 30" as per R322.2.2 FCB.
- Shower/ tub shall have floor /wall to 6" of non-absorbent, FCB, R307.2.
- There shall be a landing or floor on either side of a door as per R.311.4.3 FCB.
- Building shall have a pre-construction treatment for termites as per R320 FCB.
- All rainwater shall be retained within the property.

FIRST FLOOR PLAN  
Scale: 3/16" = 1'0"

FOR  
CONSTRUCTION

REGISTRATION/STAMP

LICENSED PROFESSIONAL ARCHITECT  
UNDER THE LAWS OF THE BAHAMAS.

LICENSE No. \_\_\_\_\_  
EXPIRATION DATE: \_\_\_\_\_

PROJECT TITLE :  
**LE CANAL  
RESIDENCE**

Lot 10, Devonshire drive  
Coral Harbor Subdivision  
New Providence  
The Bahamas

UMB BUILDING NO. : \_\_\_\_\_  
UMB Project NO. : \_\_\_\_\_  
A/E PROJECT NO. : \_\_\_\_\_  
CAD FILE NO. : 0030  
DATE : 08/05/2023

SHEET TITLE :  
**FIRST FLOOR  
PLAN**

REVISIONS

NO	DATE	ITEM

SHEET NO.  
**A-2.1**

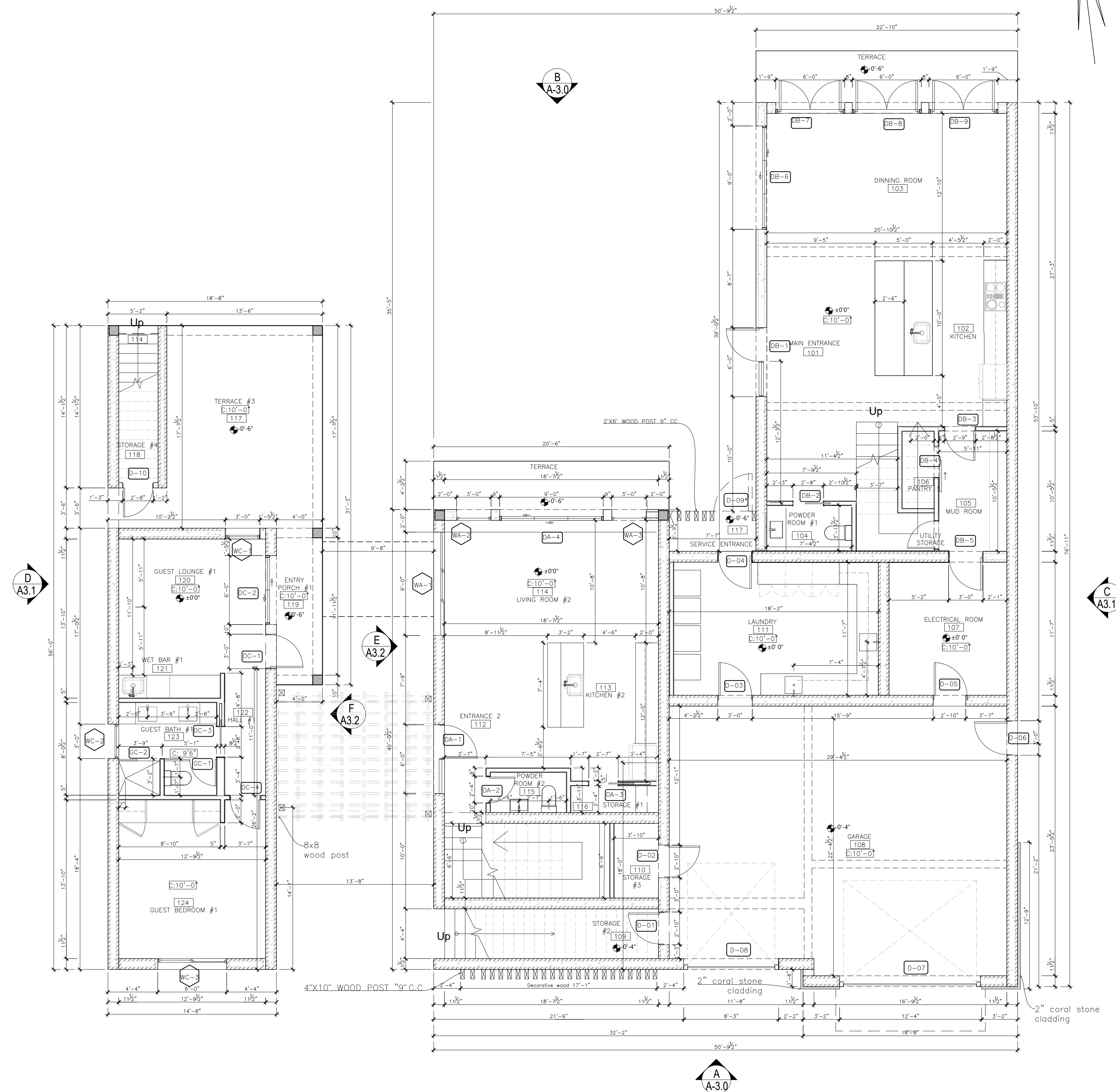

ROOM NUMBER

- |                       |                       |
|-----------------------|-----------------------|
| 101 MAN ENTRANCE      | 201 MASTER BEDROOM    |
| 102 KITCHEN           | 202 MASTER BATHROOM   |
| 103 DINING            | 203 WASHER & DRYER    |
| 104 PANTRY ROOM #1    | 204 MASTER CLOSET     |
| 105 MUD ROOM          | 205 ENTRANCE PORCH    |
| 106 PANTRY #1         | 206 LIVING ROOM #3    |
| 107 ELECTRICAL ROOM   | 207 KITCHEN #3        |
| 109 STORAGE #2        | 208 BEDROOM #3        |
| 110 STORAGE #3        | 209 BATHROOM #3       |
| 111 LAUNDRY           | 210 TERRACE #3        |
| 112 ENTRANCE #2       | 211 TERRACE #2        |
| 113 KITCHEN #2        | 212 BEDROOM #2        |
| 114 LIVING ROOM #2    | 213 BATHROOM #2       |
| 115 POWDER ROOM #2    | 214 BREEZEWAY         |
| 116 STORAGE #1        | 215 ENTRY PORCH #3    |
| 117 TERRACE #3        | 216 GUEST LOUNGE #2   |
| 118 STORAGE #4        | 217 WET BAR #2        |
| 119 ENTRY PORCH #1    | 218 HALL #2           |
| 120 GUEST LOUNGE #1   | 219 GUEST BATHROOM #2 |
| 121 WET BAR #1        | 220 GUEST BEDROOM #2  |
| 122 HALL #1           | 221 TERRACE #4        |
| 123 GUEST BATHROOM #1 |                       |
| 124 GUEST BEDROOM #1  |                       |

NOTES:

- All dimensions are done in imperial.
- Do not scale drawings. Use given dimension only.
- Use given dimensions only. All dimensions to be confirmed on site prior commencement.
- All exterior gutter, downspout assembly, rain chain links, hood vents, wet stacks, drip edges shall be in cooper.
- Attic access opening shall be 22" x 30" as per R322.2.2 FBC.
- Shower/ tub shall have floor /wall to 6' of non-absorbent. FCB, R307.2
- There shall be a landing or floor on either side of a door as per R.311.4.3 FCB.
- Building shall have a pre-construction treatment for termites as per R320 FCB.
- All rainwater shall be retained within the property.

REGISTRATION/STAMP

PROJECT TITLE :  
**LE CANAL  
RESIDENCE**

Lot 10, Devonshire drive  
Coral Harbor Subdivision  
New Providence  
The Bahamas

UMB BUILDING NO. :

UMB Project NO. :

A/E PROJECT NO. : 05-2023

CAD FILE NO. : 0030

DATE : 08/07/2023

SHEET TITLE :

**GROUND FLOOR  
PLAN**

REVISIONS

NO	DATE	ITEM

SHEET NO.

**A-2.0**

GROUND FLOOR PLAN  
Scale: 3/16"=1'0"

FOR  
CONSTRUCTION

